

## Installation Instructions

### Connections and Control Diagram

1. 4 speed nuts
2. Supporting frame
- 2a. Entrance opening 181mm
3. Fixing screws for the supporting frame
4. Camera mounting stage
5. Fixing screw to stabilize the camera on the camera mount
6. Fixing screw for vertical stabilization and half dome shell
7. Ring for horizontal adjustments
8. 1/4" screw to set the camera on the mounting stage
9. Half dome shell
10. Trim ring with a bayonet fastener

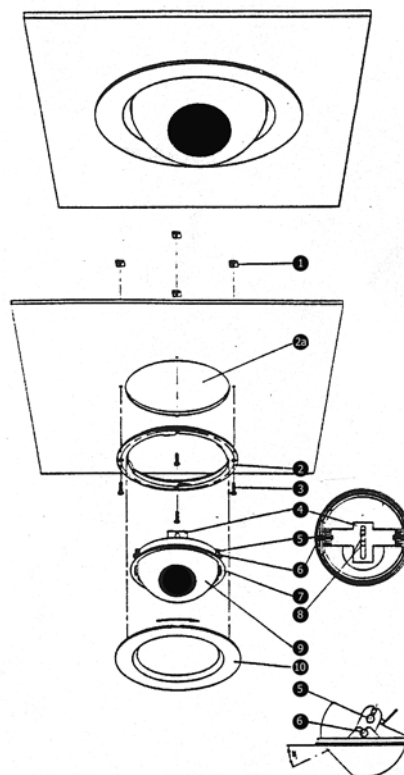

### Safety Precautions

- Do not install in oily or dusty locations
- This housing is for Indoor use only
- To clean, use a soft, moist cloth with a mild cleaning solution

### Specifications

<b>Application</b>	Dome ceiling housing for CCD cameras
<b>Location</b>	Indoors / ceiling mount
<b>Horizontal Angle View</b>	360°
<b>Vertical Inclination</b>	ca. 115° to 245° (depending on camera unit)
<b>Housing Material</b>	Polycarbonate
<b>Dimensions</b>	107mm H x 191mm Diameter
<b>Entrance Opening</b>	161mm
<b>Weight</b>	350g
<b>Camera Mount</b>	Mounting Stage
<b>Faceplate Diameter</b>	58mm