



Dome Cameras

High Resolution Color Varifocal Dome Camera

MDCH-39NA-II

Features:

- 3-9mm **computar**® auto-iris varifocal lens
- High resolution 540 TVL
- Digital Day / Night
- 3-axis manual pan/tilt rotation bracket
- Optical distortion-free dome cover
- Easy installation on wall or ceiling
- 12VDC / 24VAC dual voltage (auto-sensing)
- Includes BNC video cable and power lead

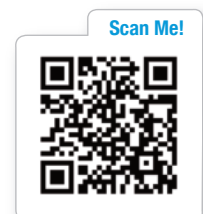

MDCH-39NA-II

High Resolution Color Varifocal Dome Camera

■ Inside View



■ Mounting Option



Model: ZC7-PM1

Compatible with Indoor
Pendant Mount

■ Parts Description

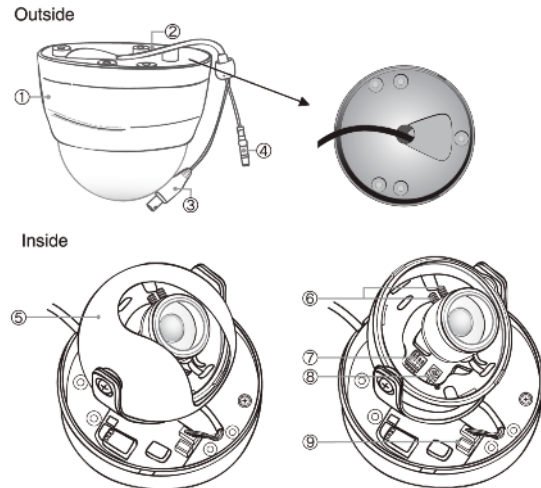

Turn Top Cover counter-clockwise to open the unit for adjustments. Once adjusted, turn the top Cover back and tighten it clockwise.

- | | |
|---------------------------|--------------------------------------|
| 1. Top cover | 6. Focus and view angle adjust lever |
| 2. Bottom cover | 7. Dip switch |
| 3. Video output connector | 8. DC iris level adjustment volume |
| 4. Power input jack | 9. Service monitor jack |
| 5. Inner cover | |

■ Specifications

| Model | MDCH-39NA-II |
|-------------------------|---|
| Image Sensor | 1/3" Color CCD |
| TV System | NTSC |
| Scanning System | 2:1 Interlace |
| Camera Resolution | 540 TVL |
| Number of Pixels | 768 (H) x 494 (V) |
| Video Output | 1.0V p-p / 75 Ω |
| Minimum Illumination | 0.4 lux / F1.2 (50 IRE) |
| Day / Night Performance | Digital Day / Night |
| S/N Ratio | More than 50dB (at minimum AGC gain) |
| Electronic Shutter | 1/60 sec. (FL OFF) / 1/100 sec. (FL ON) |
| Gamma Correction | 0.45 |
| White Balance | ATW |
| SYNC System | Internal only |
| Standard Board Lens | 3-9mm / F1.2 Auto-iris |
| Max Aperture Ratio | 1: 1.2 |
| Angle Of View | 90° ~ 31.8° Horizontal |
| Power Supply | 12V DC ± 10% / 24V AC ± 10% 60Hz ± 1Hz |
| Power Consumption | 1.8W (12V DC) / 2.5W (24V AC) |
| Operating Temperature | 14°F ~ 140°F (-10°C ~ 60°C) |
| Storage Temperature | -4°F ~ 158°F (-20°C ~ 70°C) |
| Ambient Humidity | 85% RH (Operation) / 95% RH (Storage) |
| External Dimensions | 4.7" (Ø) x 4.2" (H) / 122mm (Ø) x 106.2mm (H) |
| Weight | 0.6 lbs / 280g |
| Accessories | Self-tapping screw (3), Template, Instruction Manual, Additional Power Connector, Service Monitor Cable |

All specifications are subject to change without notice